



BRG

TECH-VENT 8000

VENTILATION LAYER FOR METAL ROOFS



Building Resources Group Pte. Ltd.

31 Tuas Ave 8, Singapore 639245
Tel: +65 6861 7091 Fax: +65 6861 7092

BRGTM
for better Insulation

Application

The Biggest Concern Today Of Most Building Owners and Architects Is Durability.

The Biggest Enemy of Most Building Materials is Moisture and Humidity.

Metal Roofs are used extensively throughout the world for Functional and Architectural Purposes. There are 2 Common Types of Systems Namely Ventilated and Unventilated Design. Both Systems call for a Drainage, Expansion Layer and Ventilation between the Metal Sheathing and Waterproofing Membrane which Seals the Building Structure. The Use Of Such Interlayer not only reduces the Oil Canning Effect (Uneven Effect Under Temperature Change), but is also Mandated by Building Directives.

TECH-VENT 8000 is a High Performance Engineered Nylon Core of Fused Entangled Filaments. 95% Of the Geomatrix is Open to Enable Undisrupted Airflow.

Installation

Tech-Vent 8000 is delivered in Rolls Size of 40m (L) x 2m (W) and weighs approximately 210 g/m². It is lightweight thus making it very easy to handle and position. The Installer Has to Roll It Out On Top Of the Waterproofing Membrane from the Apex Of The Roof TO the Eave and Cut the Length Using Simple Tools.

Benefits

- Suitable for use with zinc, copper, steel and aluminium roofing panels
- Drainage and ventilation layer with high void ratio ensuring unrestricted flow of air and water
- Reduction of rainfall noise by up to 50%
- Irregularities in substructure (nail heads, discontinuities) will not show through exterior roofing
- Allows differential movement due to temperature changes
- Entrapped moisture can diffuse out of the roofing structure
- Reduces Oil Canning Effect
- Prevents Corrosion Under Insulation and Of the Metal Roof By Allowing Entrapped Moisture To Diffuse Out Of The System

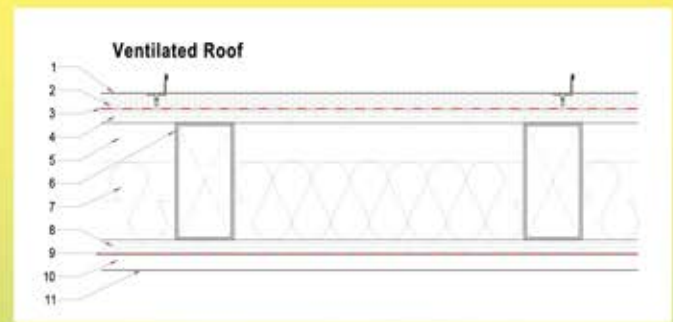

- | | |
|---|---|
| 1 Standing seam roofing
e.g. titanium/zinc or copper | 7 Thermal insulation |
| 2 Tech-Vent 8000 | 8 Plywood/OSB |
| 3 Waterproofing membrane | 9 Vapour barrier |
| 4 Plywood/OSB | 10 Support batten/cavity
for electrical work |
| 5 Air space | 11 Inner cladding |
| 6 Rafter | |

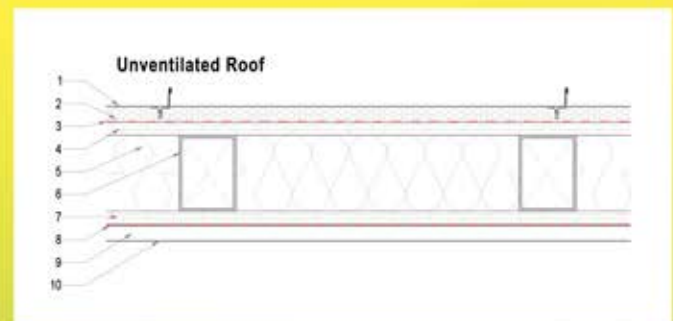

- | | |
|---|--|
| 1 Standing seam roofing
e.g. titanium/zinc or copper | 6 Thermal insulation |
| 2 Tech-Vent 8000 | 7 Plywood/OSB |
| 3 Waterproofing membrane | 8 Vapour barrier |
| 4 Plywood/OSB | 9 Support batten/cavity
for electrical work |
| 5 Rafter | 10 Inner cladding |

