

BRG

FURRING CEILING SYSTEM DRY WALL PARTITION SYSTEM



Building Resources Group Pte. Ltd.

31 Tuas Ave 8 , Singapore 639245
Tel: +65 6861 7091 Fax : +65 6861 7092

BRGTM
for better insulation

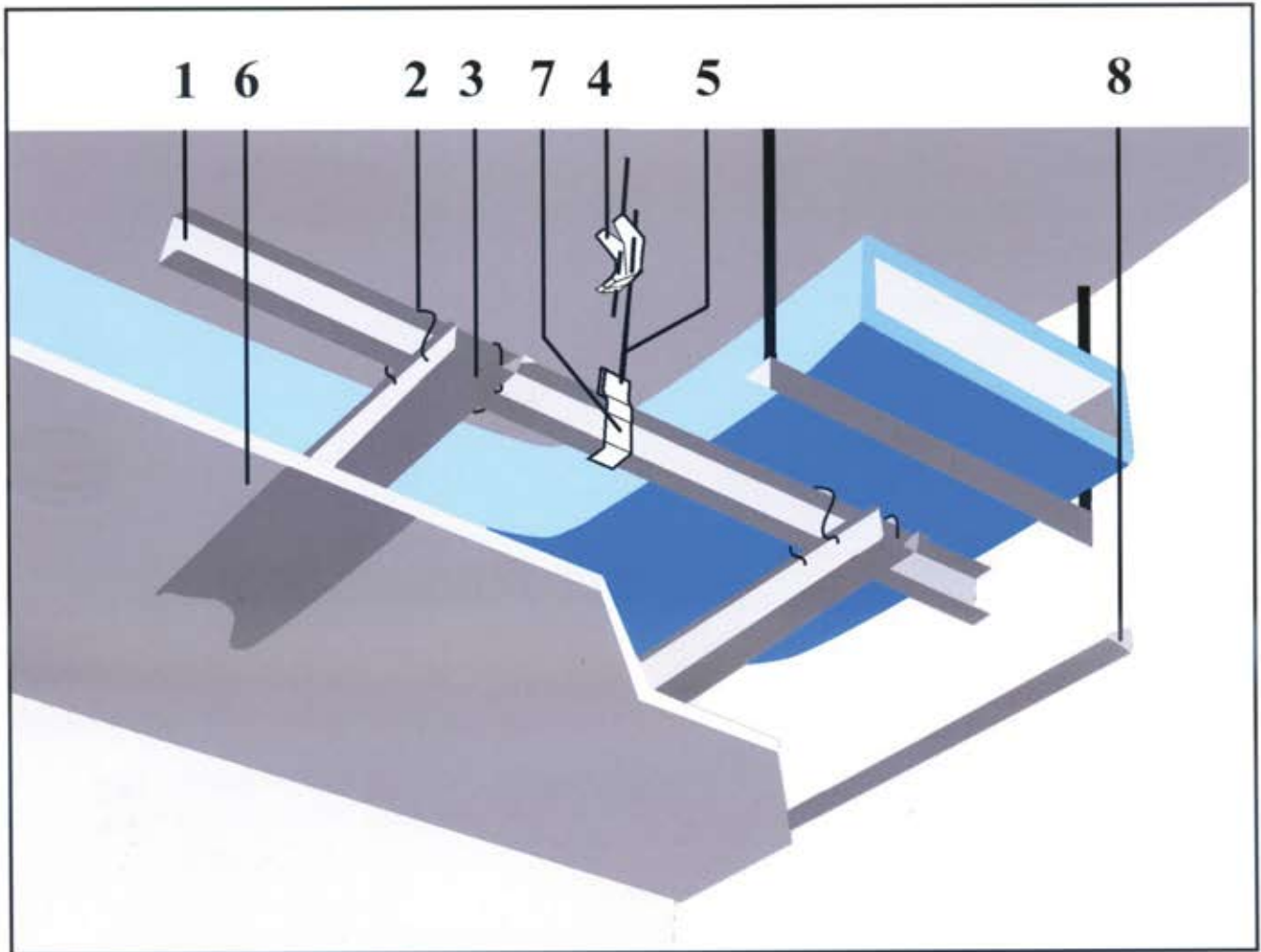

ASSEMBLY SYSTEM

1. Main Channel
2. Wire Coupling Clip
3. Furring Channel
4. Adjustable Clip
5. Wire Hanger
6. Gypsum Board
7. Channel Bracket
8. G. I. Angle

INSTALLATION STEPS

1. Use gunpowder nailing to secure the wire hangers on the ceiling.
2. Combine wire hangers and the adjustable clips, and adjust it according to the expected height of ceiling.
3. Combine the wire hangers with the channel bracket to suspend the main channel.
4. Tie the furring channels to the main channels by the wire coupling clips.
5. Screw up the GI. angle on the wall.
6. Fix the gypsum boards on the surface of furring channels and the GI. Angles.

FURRING CHANNEL

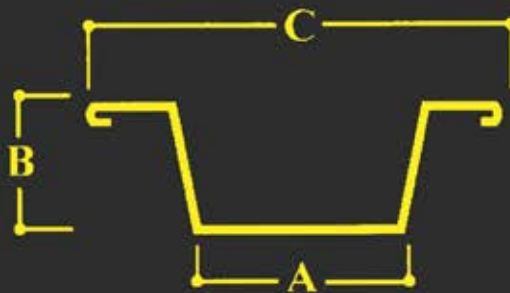
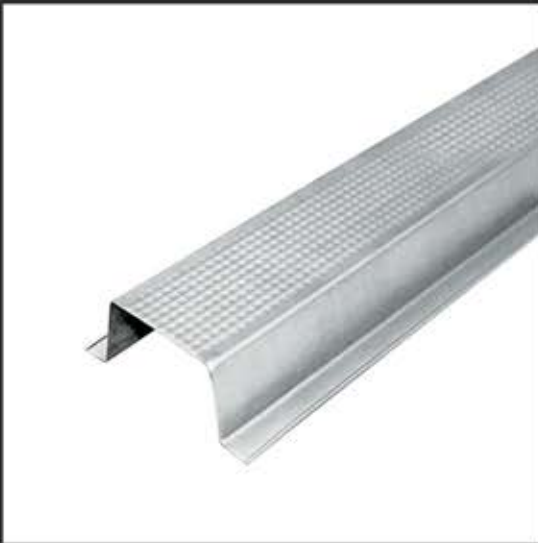



A (mm)	B (mm)	C (mm)	THICKNESS
35	22	68	0.45 to 1.0 mm

PLANE GROOVE SYSTEM

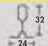
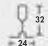
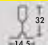
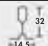
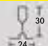

SPECIFICATION TABLE

Products	Cross-section	Height	Width
Main Tee		32 mm	24 mm
Cross Tee		32 mm	24 mm
Products	Cross-section	Height	Width
Main Tee		32 mm	14.5 mm
Cross Tee		32 mm	14.5 mm
Products	Cross-section	Height	Width
Main Tee		30 mm	24 mm
Cross Tee		30 mm	24 mm

PLANE GROOVE SYSTEM



SPECIFICATION TABLE

Products	Cross-section	Height	Width
Main Tee		38 mm	24 mm
Main Tee		32 mm	24 mm
Cross Tee		38 mm	24 mm
Cross Tee		32 mm	24 mm
Cross Tee		26 mm	24 mm
Cross Tee		24 mm	24 mm

NARROW PLANE SYSTEM



SPECIFICATION TABLE

Products	Cross-section	Height	Width
Main Tee		32 mm	14.5 mm
Cross Tee		32 mm	14.5 mm

Products	Cross-section	Height	Width
Main Tee		38 mm	14.5 mm
Cross Tee		38 mm	14.5 mm

COATING SYSTEM



SPECIFICATION TABLE

Products	Cross-section	Height	Width
Main Tee		38 mm	24 mm
Main Tee		32 mm	24 mm
Cross Tee		38 mm	24 mm
Cross Tee		32 mm	24 mm
Cross Tee		26 mm	24 mm
Cross Tee		24 mm	24 mm

ACCESSORIES



ADJUSTABLE CLIP

Use the adjustable clip to suit different height of suspension systems



CHANNEL BRACKET

Suspended by wire hanger Used to fix the Main Channel



WIRE COUPLING CLIP

For coupling Main Channel and Furring channel

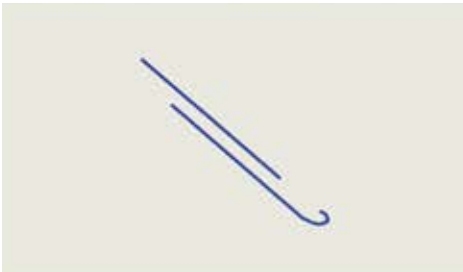

WIRE HANGER

For hanging different type of suspended systems

DRY WALL PARTITION SYSTEM

1. Dry Wall Angle
2. Track
3. Stud
4. Gypsum Board
5. Insulation

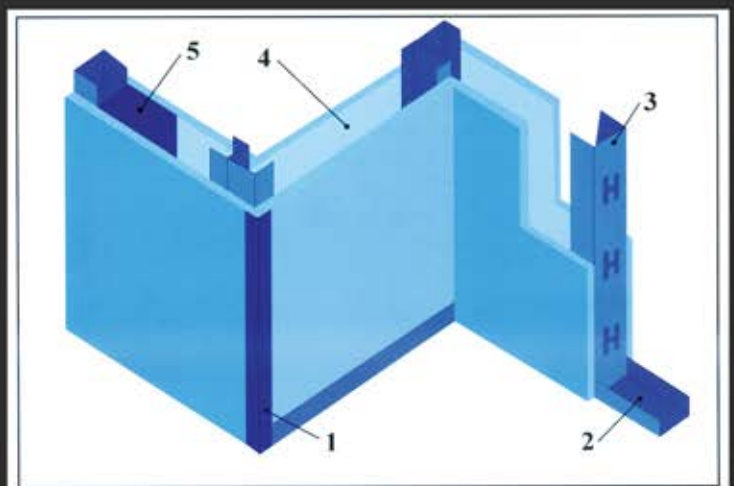

STUD

Vertically fit the stud into the track. The maximum distance between studs is 610 mm. Gypsum boards may be screwed or nailed on the both flanges. Both flanges have slide-proof points to prevent projecting screws from sliding while fixing the gypsum board.

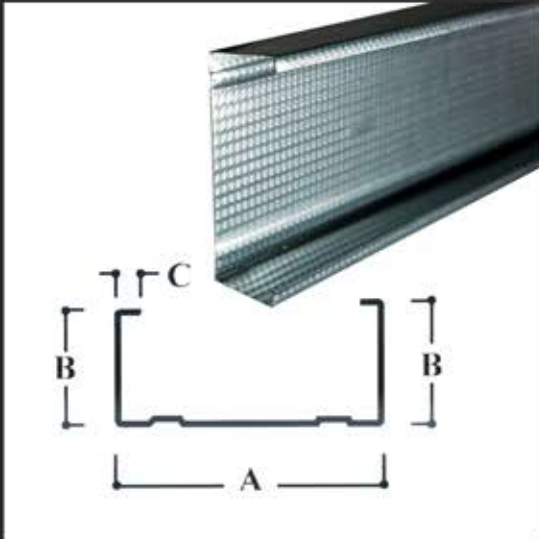

A (mm)	B (mm)	C (mm)	THICKNESS
50	32/34.5	5	0.45 to 1.0 mm
60	32/34.5	5	0.45 to 1.0 mm
70	32/34.5	5	0.45 to 1.0 mm
73	32/34.5	5	0.45 to 1.0 mm
98	32/34.5	5	0.45 to 1.0 mm
146	32/34.5	5	0.45 to 1.0 mm

TRACK

The track may be fixed on the surface of ceiling and floor by gunpowder nailing. Choose the track of different width according to the thickness of wall. Better not fix the gypsum boards on the tracks to prove a possible displacement preventing the crack and damage of wall while earthquake happens.

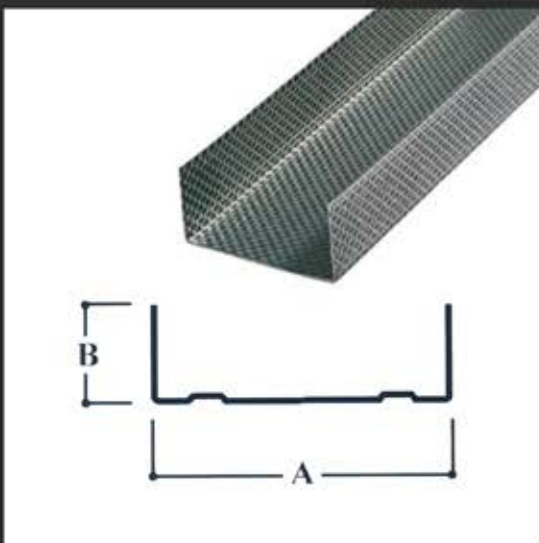

A (mm)	B (mm)	THICKNESS
52	25	0.45 to 1.0 mm
62	25	0.45 to 1.0 mm
72	25	0.45 to 1.0 mm
75	25	0.45 to 1.0 mm
100	25	0.45 to 1.0 mm
148	25	0.45 to 1.0 mm