

KIMMCO BUILDING SLAB (KBS)



www.kimmcoinsulation.com

KIMMCO

means insulation!

MANUFACTURED
UNDER LICENSE OF
ISOVER
SAINT-GOBAIN

Our Insulation Business

As the market leader in the GCC, Turkey and India, the Insulation Group has a well-established reputation for delivering high-quality, energy-efficient insulation solutions to our customers.

We have a strong commitment to quality, as recognized by our accreditation by international standard bodies (ISO, UL, DCL and others); to the environment, as recognized by our selection as the sole insulation supplier and official collaborator with MASDAR City, the world's first zero-carbon, zero-waste city, in Abu Dhabi; and to the health and safety of our people.

KIMMCO

Recognized as a leading insulation solution provider in the Middle East and Asia, KIMMCO provides insulation solutions for HVAC, building (roofs, walls, floors, metallic buildings) and technical/industrial applications. With an annual production capacity of 35,000 MT, KIMMCO is certified to ISO 9001, ISO 14001 and OHSAS 18001, and is compliant with ISO, ASTM, DIN, BS and other international standards.

SAUDI INTERNATIONAL INSULATION MANUFACTURING COMPANY (SIIMCO)

Saudi International Insulation Manufacturing Company, a joint venture between Alghanim Industries and Saint-Gobain ISOVER (France), announced the construction of a new stonewool manufacturing facility based in Yanbu Al-Sinaiyah, Kingdom of Saudi Arabia in April 2012.

SIIMCO will manufacture a variety of stonewool products for thermal and acoustic insulation. Using Saint-Gobain's state-of-the-art technology (REX process), SIIMCO will serve both the industrial and building segments. The manufacturing facility in Yanbu will have a potential of 64,000 MT installed capacity, and serve markets in Saudi Arabia as well as other markets in the GCC, Egypt, Iraq and the Levant. The plant is expected to be commissioned in early 2014.

ROCKWOOL INDIA LTD.

Rockwool India Ltd. (RIL) is recognized as the leading producer of stonewool insulation in India and has recently started serving customers in the broader GCC and MENA region. RIL operates two manufacturing facilities, one in Hyderabad and one in Silvassa, with a combined capacity of 50,000 MT per annum. RIL is a licensee of Saint-Gobain technology, and is ISO 9001 certified and ASTM compliant.

IZOCAM

IZOCAM is the leading supplier of insulation in Turkey and has been operated as a joint venture between KIMMCO and Saint-Gobain ISOVER since 2006. IZOCAM manufactures a range of glasswool, stonewool, nitrile rubber, and foam-based insulation materials and holds the ISO 9001 and ISO 14001 certificates.



KIMMCO Building Slab (KBS)

APPLICATIONS

For thermal and acoustic insulation of concrete floors in order to reduce energy losses and transmission of impact sound.

For insulation of single leaf walls with dressed stone or marble facings and cavity wall construction, precast structures and prefabricated buildings.



For thermal insulation of concrete and metal roof decks.

For thermal insulation of industrial applications: boilers, ovens, refrigerators, storage tanks, marine and road transport.

DESCRIPTION

KIMMCO Building Slabs are semi-rigid and rigid boards manufactured from stable glass fibers bonded with thermosetting resins.

Capable of withstanding the extreme temperatures encountered in industrial applications or in flat roofings, capable of withstanding normal loads met in domestic and commercial structures when used below floor screeds.

Easy to handle and cut to suit intricate shapes. Light in weight, strong and resilient.



Facings

KIMMCO Building Slabs are available unfaced or with a variety of facings to suit the application such as bitumen kraft paper, canvas, or glass reinforced aluminum foil/kraft paper laminate facing (FSK), glass reinforced aluminum foil/high intensity bleached kraft paper (ASJ), metallized polyester, black glass cloth, Aluglass.

Standard Dimensions

Thickness (mm)	Width (m)	Length (m)
25	0.4, 0.6, 1.0, 1.2	1.0, 1.2, 2.4
40	"	"
50	"	"
75	"	"
100	"	"

Non-standard sizes may be available on request.

Nominal Density

KBS	kg/m ³	lbs/ft ³	APPLICATION
24	24	1.5	Industrial
32	32	2	Industrial, walls
36	36	2.25	Industrial, walls
48	48	3	Industrial, walls
64	64	4	Industrial, walls
72	72	4.5	Industrial, walls
80	80	5	Industrial, floor, roof
100	100	6.25	Industrial, floor, roof
120	120	7.5	Industrial, floor, roof

PERFORMANCE

Working Temperature

Fiber 230 °C and 450 °C
(for ovens and boilers insulation)
upon request mentioning the working temperature.

Foil face 100 °C

At temperatures in excess of 230 °C, a limited migration of binder may occur in the insulation in contact with the hot face. This in no way impairs the performance of the insulation.

Permanence

Dimensionally stable under varying conditions of temperature and humidity, rot proof, odourless, non-hygroscopic and will not sustain vermin or fungus.

KIMMCO

means insulation!

Thermal Conductivity

The dependencies of thermal conductivity of KIMMCO TEL process products on the mean temperature and density, according to BS 874, ASTM C177, 518, ISO 8301, 8302 or DIN 52612 are presented in the tables below:

Mean Temperature	Thermal Conductivity in W/m.K for the following densities in kg/m ³										
°C	24	32	36	48	64	80	96	100	110	115	120
0	0.031	0.030	0.029	0.029	0.030	0.031	0.031	0.031	0.031	0.031	0.031
10	0.032	0.031	0.030	0.030	0.031	0.033	0.033	0.033	0.033	0.033	0.033
25	0.035	0.033	0.032	0.031	0.032	0.035	0.035	0.035	0.035	0.035	0.035
50	0.039	0.037	0.036	0.035	0.036	0.037	0.037	0.037	0.037	0.037	0.037
75	0.043	0.040	0.039	0.037	0.038	0.040	0.040	0.040	0.040	0.040	0.040
100	0.047	0.044	0.043	0.041	0.043	0.043	0.043	0.043	0.043	0.043	0.043

Mean Temperature	Thermal Conductivity in Btu.in/ft ² h.F for the below densities in Lbs/ft ³										
°F	1.500	2	2.250	3	4	5	6	6.250	6.875	7.1875	7.5
32	0.21	0.20	0.20	0.20	0.21	0.21	0.21	0.21	0.21	0.21	0.21
50	0.22	0.22	0.21	0.21	0.23	0.23	0.23	0.23	0.23	0.23	0.23
77	0.24	0.23	0.22	0.22	0.23	0.24	0.24	0.24	0.24	0.24	0.24
122	0.27	0.25	0.25	0.24	0.25	0.26	0.26	0.26	0.26	0.26	0.26
167	0.30	0.27	0.27	0.26	0.27	0.29	0.28	0.28	0.28	0.28	0.28
212	0.33	0.30	0.30	0.29	0.30	0.30	0.30	0.30	0.30	0.30	0.30

Thickness (mm)	Thermal Resistance (m ² /W.K) At 25 °C Mean Temperature							
	KBS 24	KBS 32	KBS 36	KBS 48	KBS 64	KBS 80	KBS 96	KBS 100
25	0.714	0.758	0.781	0.806	0.781	0.714	0.714	0.714
40	1.143	1.212	1.250	1.290	1.250	1.143	1.143	1.143
50	1.429	1.515	1.563	1.613	1.563	1.429	1.429	1.429
65	1.859	1.970	2.031	2.097	2.031	1.859	1.859	1.859
75	2.143	2.273	2.344	2.419	2.344	2.143	2.143	2.143
100	2.857	3.030	3.125	3.226	3.125	2.857	2.857	2.857

Thickness (inch)	Thermal Resistance (ft ² h.F/Btu) at 77 °F Mean Temperature							
	KBS 24	KBS 32	KBS 36	KBS 48	KBS 64	KBS 80	KBS 96	KBS 100
1	4.121	4.371	4.507	4.653	4.507	4.121	4.121	4.121
1.5	6.182	6.556	6.761	6.979	6.761	6.182	6.182	6.182
2	8.242	8.742	9.015	9.306	9.015	8.242	8.242	8.242
2.5	10.303	10.927	11.269	11.632	11.269	10.303	10.303	10.303
3	12.363	13.113	13.522	13.958	13.522	12.363	12.363	12.363
4	16.484	17.483	18.030	18.611	18.030	16.484	16.484	16.484

These are typical values subject to normal manufacturing and testing variances.

Fire Safety

Base fibers are non-combustible when tested in accordance with BS 476 (part 4) ASTM E136, and ISO 1182.

KIMMCO Building Slabs have been tested and listed by the Underwriters Laboratories according to UL 723 (file R 9703).

Glass reinforced aluminium/kraft laminate facing (FSK) are U.L. classified as follows:

Flame spread : not over 25

Smoke developed : not over 50

Moisture Absorption

Less than 1% by volume when tested in accordance with BS 2972 or 6676, ASTM C1104. KIMMCO Building Slabs do not absorb moisture from the ambient air nor water by capillary attraction. Only water under pressure can enter the insulation products, but that will quickly dry out owing to the material's open cell structure. FSK faced KIMMCO Building Slabs comply with ASTM E96 desiccant method. Permeance not to exceed 0.02 perms (Federal standard HH-B-100B Type 1).

NON TOXIC

KIMMCO Building Slab is not hazardous to health. (See KIMMCO MSDS)

Acoustic Performance

ASTM C423 - Mounting A as per ASTM E795

Product Type	Thickness (mm)	Absorption Coefficient of one-third octave frequencies Hz						
		125	250	500	1,000	2,000	4,000	NRC
KBS 48	50	0.16	0.52	0.89	0.92	1.03	0.95	0.85
KBS 64	25	0.18	0.29	0.69	0.80	0.90	0.89	0.65
	50	0.21	0.48	1.02	1.00	1.00	0.96	0.85
KBS 120	25	0.00	0.25	0.85	0.98	1.00	0.80	0.75
	50	0.22	0.76	0.92	0.96	0.98	0.87	0.90

These are typical values subject to normal manufacturing and testing variances.

CONFORMITY TO STANDARDS

KIMMCO Building Slabs comply with the following standards:

American Standards

ASTM C165, 167, 168, 177, 303, 356, 411, 423, 518, 612 (class 1 to 3), 665 § 13.8 & 13.9, 1045, 1101/1101M, 1104/1104M, 1136 (type 1&2), 1335; E84, 96, 136, 795

UL723

F.S. HH-B-100B (Type 1), HH-521F, HH-558B

NFPA255

NAIMA Standards ASHRAE 90.1 requirements

British Standards

BS 476 (parts 4, 6 & 7), 874, 2972, 3533, 3958 (part 5) 6676 (part 1)

German Standards

DIN 18165, 52612

ISO

354, 1182, 8301, 8302, 9229, 9291

TYPICAL INSTALLATION

Concrete Floors Above D.P.C. Level

Cover concrete floorslab with a suitable damp proof membrane, ensuring adequate coverage at joints. Membrane should be taken up vertical surfaces to finished screed level. KIMMCO Building Slab is laid directly on top of the damp proof membrane with edges close butted and joints staggered. Edge insulation consisting of strips of insulation not more than 2.5 cm thick cut from standard slab with a width to suit the specified screed thickness should be placed vertically against the walls, the bottom edge resting on top of the horizontal

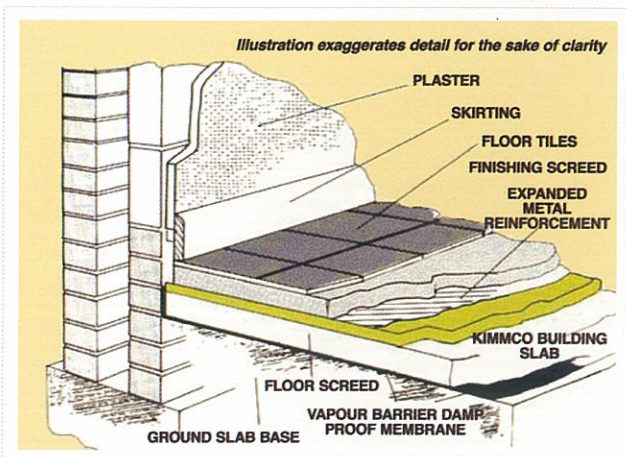

and vertical insulation with care taken to ensure that laps are well covered. It is recommended that the screed should be 60 mm thick with a galvanised mesh reinforcement laid into it.

Cavity Walls

Use galvanized, stainless steel or nylon hangers with retaining washers for holding the insulation in correct position.

The 2" FSK overlap of KIMMCO Building Slab to be positioned at the bottom of each slab in order to cover the top of the underlying slab to protect the insulation from accidental water spillage during the outside wall construction.

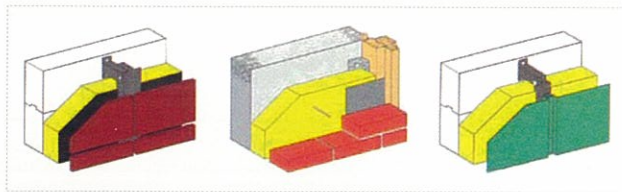
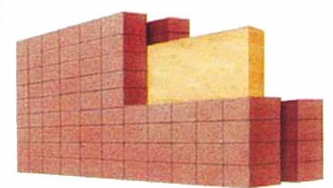

Cavity Walls With Ties

Construction methods are only slightly affected by the use of KIMMCO Building Slab. The inner leaf of the wall construction should be cleaned of mortar protrusions before fitting KIMMCO Building Slab between each horizontal run of wall ties. Mortar droppings should be removed from top edges of insulation before placing the next row in position. The insulation must be placed against the outer face of the inner leaf of the wall. A minimum air gap of 1 cm should be left between the insulation and the inner face of the external wall leaf. This ensures normal drainage and ventilation of the cavities. Joints between insulation slabs must be close butted with all vertical joints staggered.

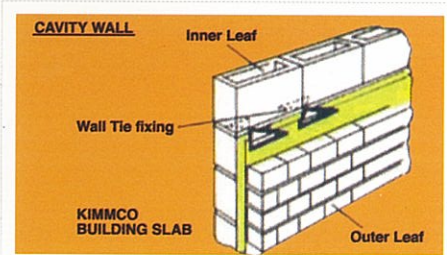

KIMMCO Building Slabs are held back against the face of the inner leaf by the drip prong of the wall ties, special clips or adhesive. In applications using marble or stone facings, it is important that the facing be tied back to the main structure, the ties to be inserted at joints between the insulation. Type and frequency of fixing depends on size and weight of facing material specified.

KIMMCO

means insulation!

Solid Wall Construction

Insulation can be applied to the back up wall in one of the following manners:

A. Batten out surface of wall to suit width of slabs ensuring that KIMMCO Building Slab can be fixed snugly between battens without gaps. Apply a vapour barrier over the KIMMCO Building Slab, fixing it to the battens with staples or flat head nails. Vapour barrier to be applied horizontally with each run overlapping previous by at least 15cm. Fix expanded metal, galvanized chicken mesh or plastic netting over the vapour barrier as a key for the rendering, fixing it into the vertical battens by staples or flat head nails. Some additional fixing may be required between battens to remove excess bellying. Apply external render coats or plaster board.

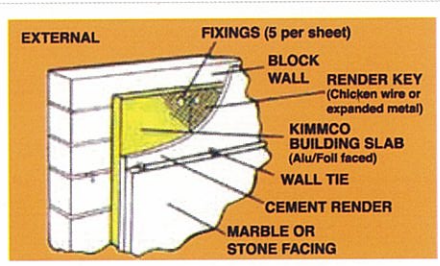

B. Apply foil faced KIMMCO Building Slab to the wall with recognized mechanical fastenings such as Hilti using large head washers. Insulation should be applied with staggered vertical joints. All boards to be close butted. Apply expanded metal, galvanized chicken mesh or plastic netting over the insulation using mechanical fasteners. External rendering or other facing can now be applied.

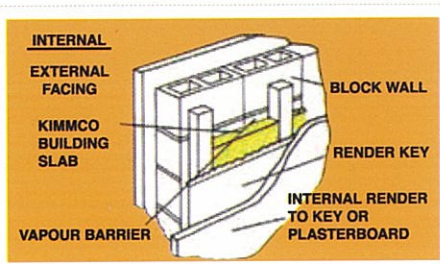

C. KIMMCO recommends that metal wall ties or wires be used to tie the external wall finish (marble or stone) to the internal wall. This gives additional stability to the structure. Care should be taken to ensure that the wall ties are long enough to reach through the insulation to the external finish.

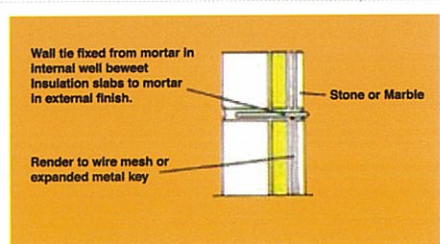

KIMMCO recommends to seal all joints where vapour barriers are used.

Concrete Roofs

The roof surface should be clean and dry. A perfectly smooth surface to the concrete is not necessary but care should be taken to ensure the boards do not rock.

KIMMCO Building Slab should be bedded in a bitumen compound on top of an approved continuous vapour barrier with well lapped joints. Weathering treatments should be laid in accordance with manufacturers instructions.

A reflective surface finish should be applied to reduce absorption of solar heat.

KIMMCO Building Slab can be used with synthetic membranes by sticking, in accordance with the membranes manufacturers specifications.

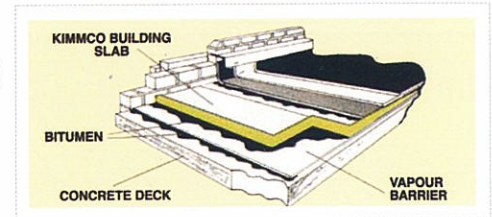

Metal Roofs

KIMMCO Building Slab may be applied to metal roof decks by bitumen adhesion or by mechanical fixings. For bitumen compound on top of a continuous vapour barrier, care must be taken to ensure that joints between boards are supported by the deck profiles and are not laid with the open flutes running continuously beneath. It is recommended that the insulation be placed at a 45 deg. angle to the line of the deck flutes.

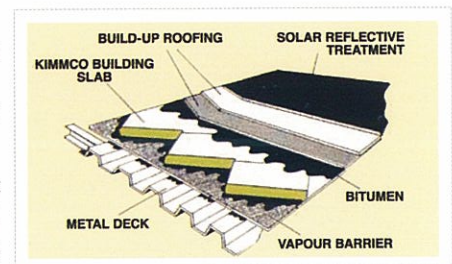

For mechanical fastening, one of several methods may be used, i.e. Lexscuco clips or screw and washer fixings. Washers should be 50 mm in diameter with a large countersink cup so that screw heads do not protrude above insulation.

False Ceiling

Falls should be incorporated in roof deck construction by contractor.

Access Roofs

KIMMCO Building Slab laid directly beneath weather proofing such as built up roofing is suitable for roofs carrying normal light maintenance traffic. A finish of concrete tiles or similar should be applied where continuous foot traffic is expected.

KIMMCO Building Slab should not be used for roof decks where heavy point loadings can be expected or where vehicles of any type will be used.

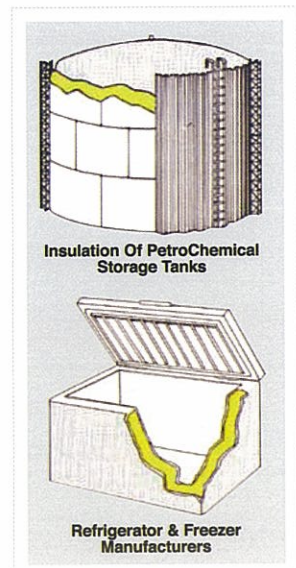

Typical Industrial Application.

Commitment to Quality

Properties of KIMMCO Glasswool Products

- Excellent thermal performance
- Superior acoustic performance
- Excellent fire safety
- Environmentally friendly: made from abundantly available, non-strategic materials like sand and up to 80% recycled glass.
- Suitable for a wide variety of applications (flexible, semi-rigid, rigid and extra-rigid)
- Address a variety of performance requirements (wide range of facing materials)
- Easy to cut and install, minimum wastage on site
- Comparatively light weight
- Dimensionally stable
- No sagging or settling
- Complies with international standards

Our Commitment to Quality

Our Glasswool products are manufactured under license of Saint-Gobain ISOVER, a leading insulation provider headquartered in France.

Further, we have a strong commitment to quality, as recognized by our certification by international bodies such as ISO.

Our Commitment to the Environment

KIMMCO was selected as the sole insulation supplier and official collaborator with MASDAR city, the world's first zero-carbon, zero-waste city, in Abu Dhabi. We have a strong commitment to the environment, health and safety of our people, and surrounding communities, and actively collaborate with local and international environmental agencies.

Further, KIMMCO Glasswool products help developers achieve green building rating certifications such as LEED, Estidama and QSAS.

Further, we are members of the following industry associations:

- Emirates Green Building Council (EGBC)
- Qatar Green Building Council (QGBC)
- MASDAR (The Future Build)
- Middle East Minerwool Insulation Manufacturers Association (MEMIMA)

Our Product Listing & Certification

- CE
- UL
- BV
- ABS
- DCL (Dubai Central Laboratory)



KIMMCO

means insulation!

KIMMCO

Kuwait Insulating Material Manufacturing Co.

P.O. Box 10042 Shuaiba, 65451 Kuwait

Tel : +965 188 1111

Fax : +965 2326 1251

| kimmco@alghanim.com |
| www.kimmcoinsulation.com |

The KIMMCO logo consists of the word "KIMMCO" in a bold, black, sans-serif font. It is flanked by two horizontal orange bars, one above and one below the text.

means insulation!